

## G3800S Stainless Steel Cam Lock

### Features

- Nickel silver key with excellent corrosion and abrasion resistance
- Highly durable with thick cam
- Non-handed
- Reversible key can only be removed when locked (90° rotation), and ensures that the application is properly locked
- 300 key changes available. Master key system available on request (max. 300 key changes per master key)

### Notes

- Not waterproof



### Cut Out Dimensions

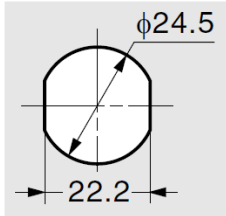

### Installation

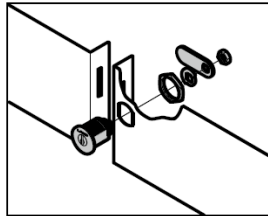

### Installing to Right-handed Door

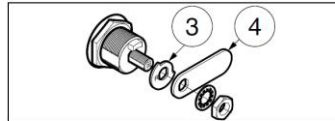

After installation, ensure that the "R" mark on cylinder cam and the "Logo" mark on cam are in normal direction (as seen from the back of lock).

### Installing to Left-handed Door

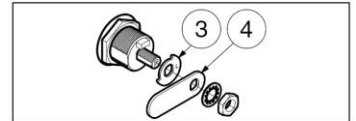

After installation, ensure that the "L" mark on cylinder cam and the "Logo" mark on cam are in normal direction (as seen from the back of lock).

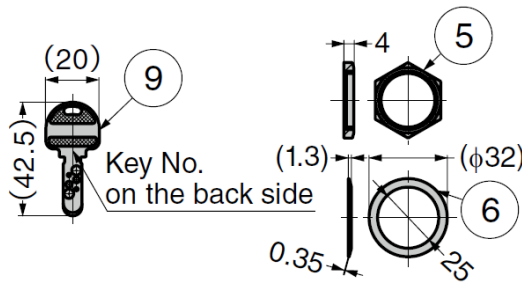
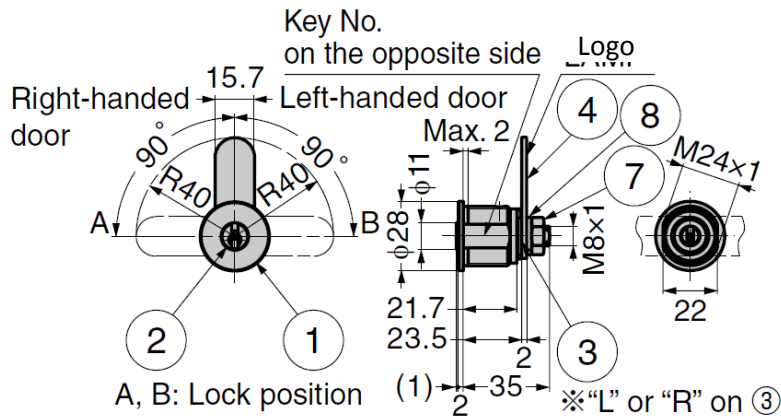

No.	Part Name	Material	Finish
①	Cylinder (Outer)	Stainless Steel (SUS303)	Satin
②	Cylinder (Inner)		
③	Cylinder Cam	Stainless Steel (SUS304)	2B Finish
④	Cam		
⑤	Nut (for Installing the Body)	Stainless Steel (SUS303)	Plain
⑥	Washer (for Body)		
⑦	Nut (for Installing the Cam)	Stainless Steel	Plain
⑧	Washer		
⑨	Key	Nickel Silver	
-	Key Ring	Stainless Steel (SUS304)	

※Cylinder pin is made of brass.

Part No.	Key Type	Door Thickness
G3800S-B	Key Differently	2 ~ 10
G3800S-D	Keyed Alike	